

**BLACK+
DECKER**™



BXCM0101IN

Parts Identification

1. Filter
2. Filter holder
3. Support clip
4. Cup
5. Removable stand
6. Lid
7. Water outlet
8. Water tank
9. Filter holder support
10. Indicator
11. On/Off Switch
12. Base

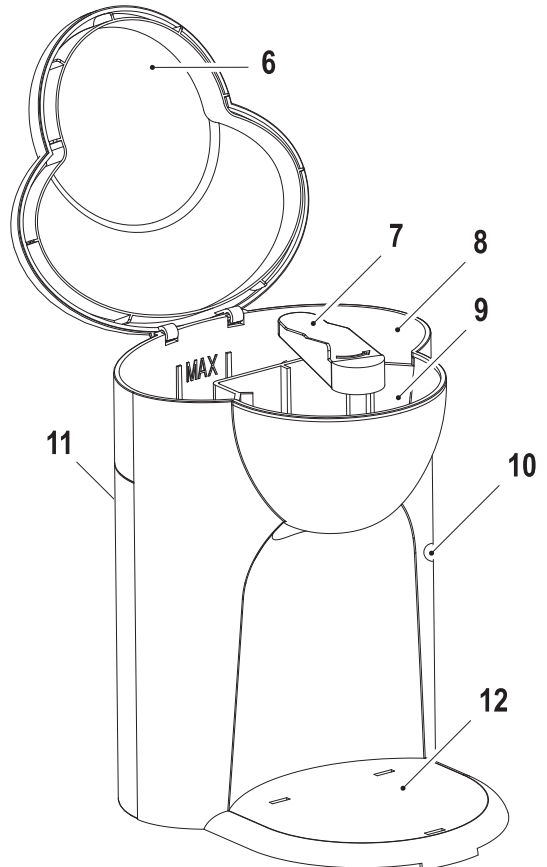
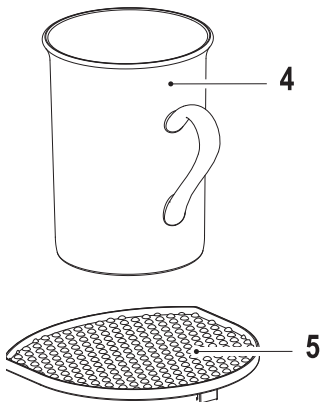
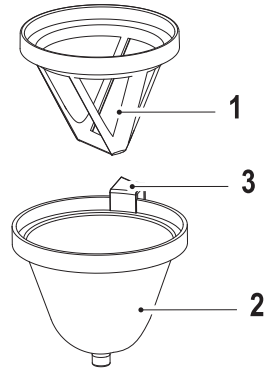

Intended use

Your Black+Decker coffee maker has been designed for making coffee.

- This appliance is intended to be used in household and similar applications.
- This appliance is not intended to be used in:
 - Staff kitchen areas in shops, offices and other working environments;
 - Farm houses;
 - By clients in hotels, motels and other residential type environments;
 - Bed and breakfast type environments;
 - Or any other non-household environments.

Safety instructions



Warning! When using mains-powered appliances, basic safety precautions, including the following, should always be followed to reduce the risk of fire, electric shock and personal injury.

- The intended use is described in this manual. The use of any accessory or attachment or the performance of any operation with this appliance other than those recommended in this instruction manual may present a risk of personal injury.
- Retain this manual for future reference.

Using your appliance

- Always take care when using the appliance.

- Do not use the appliance outdoors.
- Do not operate the appliance if your hands are wet. Do not operate the appliance if you are barefoot.
- Guide the power supply cord neatly so it does not hang over the edge of a worktop and cannot be caught accidentally or tripped over.
- Never pull the power supply cord to disconnect the plug from the socket. Keep the power supply cord away from heat, oil and sharp edges.
- If the power supply cord is damaged during use, disconnect the appliance from the power supply immediately. Do not touch the power supply cord before disconnecting from the power supply.
- Disconnect the appliance from the power supply when not in use and before cleaning.

Safety of others

- This appliance is not intended for use by persons (including children) with reduced physical sensory or mental capabilities, or lack of experience and knowledge, unless they have been given supervision or instruction concerning use of the appliance by a person responsible for their safety.
- Children should be supervised to ensure that they do not play with the appliance.

After use

- Switch off, remove the plug from the socket and let the appliance cool down before leaving it unattended and before changing, cleaning or inspecting any parts of the appliance.

- When not in use, the appliance should be stored in a dry place. Children should not have access to stored appliances.



This product must be earthed. Always check that the mains voltage corresponds to the voltage on the rating plate.

Inspection and repairs

- Switch off the appliance before cleaning, changing accessories or approaching parts which move in use
- Before use, check the appliance for damaged or defective parts. Check for breakage of parts, damage to switches and any other conditions that may affect its operation.
- Do not use the appliance if any part is damaged or defective.
- Have any damaged or defective parts repaired or replaced by an authorised repair agent.
- Before use, check the power supply cord for signs of damage, ageing and wear.
- Do not use the appliance if the power supply cord or mains plug is damaged or defective.
- If the power supply cord or mains plug is damaged or defective it must be repaired by an authorised repair agent in order to avoid a hazard. Do not cut the power supply cord and do not attempt to repair it yourself.
- Never attempt to remove or replace any parts other than those specified in this manual.

Electrical safety

Before use, check that the mains voltage corresponds to the voltage on the rating plate.

- Appliance plugs must match the outlet. Never modify the plug in any way. Do not use any adapter plugs with earthed (Class 1) appliances. Unmodified plugs and matching outlets will reduce the risk of electric shock.

Extension cables & class 1 product

- A 3 core cable must be used as your tool is earthed and of class 1 construction.
- Up to 30m (100 ft) can be used without loss of power.
- If the supply cord is damaged, it must be replaced by the manufacturer or an authorised Black+Decker Service Centre in order to avoid a hazard.

Mains plug replacement

If a new mains plug needs to be fitted:

- Safely dispose of the old plug.
- Connect the brown lead to the live terminal of the new plug.
- Connect the blue lead to the neutral terminal.
- If the product is class I (earthed), connect the green/yellow lead to the earth terminal.

Note: If your product is class II double insulated (only 2 wires in the cord set), no connection is to be made to the earth terminal.

Follow the fitting instructions supplied with good quality plugs.

Any replacement fuse must be of the same rating as the original fuse supplied with the product.

Warning! The above section on mains plug replacement is for authorized service centre personals.

Additional safety instructions for coffee makers

Warning! The lid may become hot during use.

Warning! Steam may escape from the unit.

- Allow the appliance to cool before touching or removing any parts and before cleaning.
- Do not immerse the appliance in liquid.

Use

Warning! Never use the appliance without water in the reservoir.

Before first use

- Unpack the coffee maker and remove all packaging, promotional materials and stickers. Remove all printed documents.
- Check that your mains supply is the same as the one indicated on the appliance.
- Position the appliance on a flat, stable work surface, away from the edge and other electrical appliances. Ensure that the coffee maker is not positioned under any cupboards or near any furnishings, wallpaper or similar that could be damaged by hot steam.
- Wash all removable parts of the appliance in warm, soapy water. Rinse and dry thoroughly with a soft cloth.

Do not use harsh/abrasive cleaners or place any part of the appliance in the dishwasher.

Warning! Never immerse the main body of the appliance, cord set or plug in water or any other liquid.

- We recommend that you first familiarise yourself with all parts of the appliance before using it for the first time. Do not fill with water or connect to the mains supply when doing this.
- To remove any remaining residue from the manufacturing process, we recommend operating the coffee maker as described in the 'Use' section. This will flush the appliance out. Use water only, do not add coffee.

Note! Ensure that the coffee maker mains cord does not overhang the edge of the worktop.

Note! When the coffee maker is plugged in and operated for the first time, there may be a small amount of smoke and/or odour as the heating elements warm up. This represents no danger or malfunction with the product and should clear after a couple of uses.

Adding coffee

- Place the filter (1) in the filter holder (2). Add the desired amount of coffee.
- Open the lid (6).
- Rotate the water outlet (7) towards the back of the appliance and place the filter holder (2) in the filter holder support (9). Make sure the support clip (3) on the filter holder (2) fits securely over the recess on the right hand side of the filter holder support (9).
- Rotate the water outlet (7) back towards the front of the appliance so it is over the coffee in the filter (1).

Adding water

Using the cup (4), fill the water tank (8) with the desired quantity of COLD water.

- Close the lid (6).

Note! Do not fill above the MAX mark in the water tank.

Warning! DO NOT open the lid (6) whilst the coffee maker is on. Hot water may be ejected.

Switching on and off

- To switch the appliance on, press the on/off button (11).
- To switch the appliance off, press the on/off button (11) again.

Brewing coffee

- Ensure that the removable stand (5) is fitted into the base (13).
- Add coffee as described.
- Add water as described.
- Close the lid (6)
- Place the cup onto the removable stand.
- Switch the appliance on. (The indicator light (12) on the right side of the appliance will come on).

Note! This product does not have an anti drip nozzle. Switch the appliance off and wait for the coffee to stop flowing before removing the cup.

Cleaning and maintenance

Warning! Before cleaning and maintenance, switch the appliance off and remove the plug from the socket.

- Remove the filter (1) and the filter holder (2) from the filter holder support (9). Remove the used coffee grounds from the filter.
- Remove the water outlet (7) by pulling it upwards.
- Wash the cup (4), water outlet (7) filter holder (2) and the filter (1) in hot, soapy water. Rinse then dry all parts thoroughly then re-fit them.
- Wipe the outside of the appliance with a damp cloth.

De-scaling the appliance

If the appliance is used in an area with hard water, it is advised to de-scale the appliance when from time to time.

- Use a commercial de-scaling agent for coffee makers, or use water and white vinegar as follows:
- Fill the water tank (8) and add 3 teaspoons of vinegar. Operate the appliance as for making coffee until the reservoir is empty.
- Discard the used water and repeat the procedure 2 or 3 times with fresh water.

Technical data

Model	: BXCM0101IN
Voltage	: 220-240V AC, 50 Hz / 60 Hz
Power	: 330 W
Weight	: 0.59 Kg

WARRANTY TERMS AND CONDITIONS

Stove Kraft Limited warrants to the purchaser of products for a period of 2 Years commencing from the date of invoice, the company will repair or replace free of charge any part or parts of the product, should the company be fully satisfied in its sole discretion, that the defect/s is/are due to faulty material or workmanship only. The warranty will be governed by the following clauses.

- 1) The company or their Authorised Service Agent will repair / replace all parts that are failing due to faulty material or defective workmanship pertaining to the aboveproduct.
- 2) Only the Company or its Authorised Service Agent can service / repair or attend to install/reinstall the above product.
- 3) On-site warranty will be executed. The warranty will be executed at customer place / authorized dealer / service centers and in which the authorized representative is situated including outstation locations.
- 4) The warranty extended herein is in lieu of all implied conditions & warranties under the law and is confined to the repair or replacement of defective parts and does not cover any consequential or resulting liability, damage or loss arising from such defects. Further more, the warranty in no case shall extend to the payment or any monetary consideration whatsoever, of the replace ment or return of the product as a whole.
- 5) This warranty excludes consumables, corrosive, plastic, rubber and glass components adding decorative value to the product.
- 6) The company is not liable to carry out any servicing work under the warranty.
- 7) The courts of competent Jurisdiction at Bangalore, Karnataka shall have exclusive Jurisdiction over all matters arising out of any disputes in relation to product.
- 8) Stove Kraft shall not be liable to replace or repair the good under the terms of warranty
where:
 - a) The fault has been caused or is attributable to accidental use, misuse, negli gent use or used contrary to the manufacturer recommendation
 - b) The appliance has been used on a voltage supply other than that stamped on the product.
 - c) Repairs have been attempted by persons other than the company or their authorized service agent.

Imported & Marketed by

Stove Kraft Limited

An Iso 9001 : 2015 Certified Company

#81, Harohalli Industrial Area, Kanakapura Taluk, Ramanagara District - 562 112, Karnataka, India

for Customer Complaints, Contact:

Customer Care Address: Same as Above, Manager, Consumer Care Cell

Toll Free Number - 180042520202 | Email: bd.customercare@stovekraft.com

Country of Origin: People's Republic Of China



WARRANTY REGISTRATION FORM

YOUR NAME _____

YOUR ADDRESS _____

POSTCODE _____

DATE OF PURCHASE _____

DEALERS NAME & ADDRESS _____



PRODUCT MODEL NO.
BXCM1201IN